

Series 770

Bidirectional O-Ported Slide Gate Valve



Bray / VAASTM

2"-24" (50-600mm) 150psi (10bar)

Series 770

Bidirectional O-Ported Slide Gate Valve

The Bray/VAAS Series 770 is a bidirectional o-ported slide gate valve, designed for severe service applications. The 770's o-ported gate is in constant contact with the seats, minimizing seat stress and ensuring maximum sealing performance.

The durable ductile iron body is offered in a compact wafer style. When fully open, the valve is full bore, offering no resistance to line media.

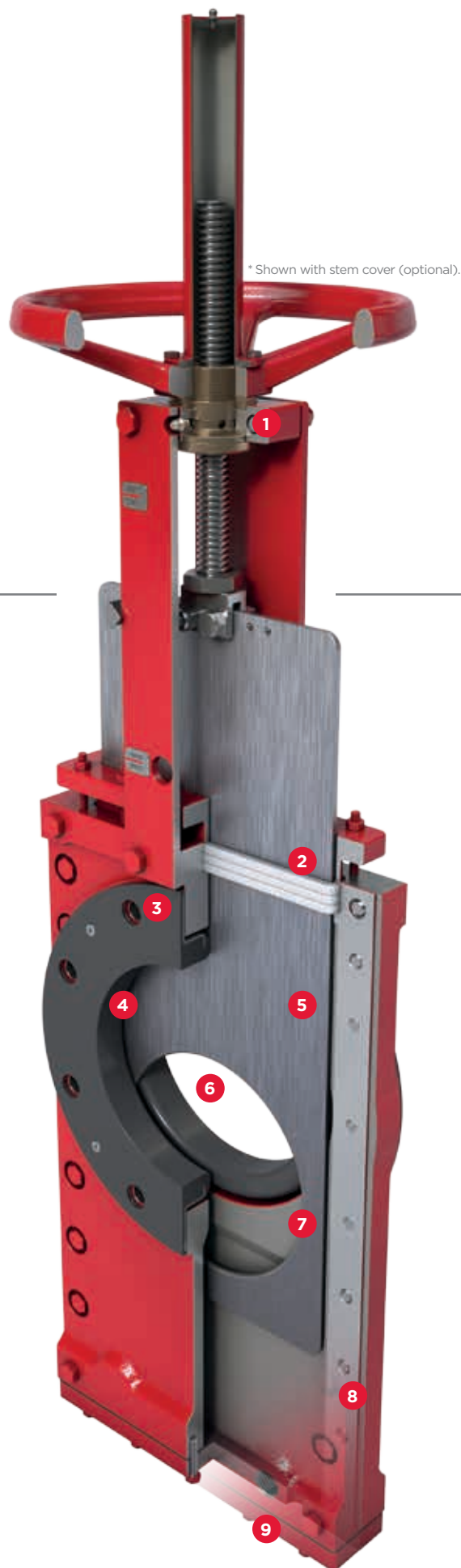

- 1 Designed for easy, quick conversion between manual and pneumatic actuation. Featuring a lubricant injection port for continuous, smooth operation with minimal maintenance.*
- 2 Multi-layer square packing provides exceptional gland sealing.
- 3 Replaceable steel reinforced, elastomer seat ensures bi-directional zero leakage shutoff.
- 4 Seats are in constant contact with gate throughout the entire stroke of the valve.
- 5 Deflection resistant gate design ensures consistent alignment for industry leading durability.
- 6 Unrestricted flow path with minimal pressure drop achieved through full port valve design.
- 7 The inherent design of the o-ported slide gate provides 360° scale-breaking.
- 8 Compact wafer body allows for easy installation and is drilled and tapped to ASME CL150 flange patterns as standard. Other drilling options available upon request.
- 9 Non-discharging body design includes tapped flush ports as standard, allowing for safe discharge of media and easy flush water connection.

Standard Construction

Body	Gate	Seat	Stem	Gland	Packing	Topworks
DI	304	EPDM	304	CS	PTFE	Steel
CF8	304	EPDM	304	CS	PTFE	Steel
CF8M	316	EPDM	304	CS	PTFE	Steel

Body Options

Carbon Steel (WCB)
CF8 Stainless Steel
CF8M Stainless Steel
CF3M Stainless Steel
SAF 2205 Duplex
SAF 2507 Duplex

Gate Options

304, 316, 317 Stainless Steel
SAF 2507 Duplex
17-4PH Stainless Steel
Hastelloy® C
Monel®
Titanium

Seat Options

Buna-N -35°-194°F/-37°-90°C
EPDM -65°-248°F/-54°-120°C
Viton® -15°-392°F/-26°-200°C
PTFE -235°-450°F/-148°-232°C

Actuator Options*

Bevel Gear
Pneumatic
Hydraulic
Electric

*Direct Mounted Handwheel (Standard).

Packing Options

PTFE 232°C/450°F
Elastomer 90°C/194°F
Quad Seal* 200°C/392°F
Copper 500°C/932°F
Wiper
Graphite 1000°C/1832°F

*PTFE with Buna-N or Viton®.

Specifications & Standards

Size Range	2" to 24" (50 - 600mm)
Pressure Rating	150psi (10bar) CWP
Body Style	Wafer, two-piece bolted

Design	MSS SP-81
Testing	MSS SP-81
Face-to-face	MSS SP-81
Certification	Canadian CRN
Drilling	ASME B16.5 CL150, ASME B16.47 CL150

Dimensions

In. (mm)	A	PCD-B	C	D	E	ØF	G	H	I	ØJ
2 (50)	1.88 (48)	4.75 (121)	6.5 (165)	15.15 (385)	15.74 (400)	10.00 (254)	19.29 (490)	--	--	--
3 (80)	2.00 (51)	6.00 (153)	7.9 (200)	16.53 (420)	18.50 (470)	10.00 (254)	23.42 (595)	--	--	--
4 (100)	2.00 (51)	7.50 (191)	9.84 (250)	19.09 (485)	22.83 (580)	10.00 (254)	26.18 (665)	--	--	--
6 (150)	2.25 (57)	9.50 (242)	13.38 (340)	23.42 (595)	27.55 (700)	12.00 (305)	34.05 (865)	--	--	--
8 (200)	2.75 (70)	11.75 (299)	17.71 (450)	26.37 (670)	35.03 (890)	12.00 (305)	41.33 (1050)	--	--	--
10 (250)	2.75 (70)	14.25 (362)	20.07 (510)	30.11 (765)	39.76 (1010)	15.98 (406)	46.65 (1185)	46.45 (1180)	9.68 (246)	19.68 (500)
12 (300)	3.00 (76)	17.00 (432)	22.83 (580)	32.87 (835)	46.06 (1170)	20.00 (508)	53.34 (1355)	51.18 (1300)	9.68 (246)	19.68 (500)
14 (350)	3.00 (76)	18.75 (476)	24.80 (630)	35.82 (910)	51.18 (1300)	20.00 (508)	57.67 (1465)	57.08 (1450)	9.68 (246)	19.68 (500)
16 (400)	3.50 (89)	21.25 (540)	27.95 (710)	--	--	--	65.74 (1670)	61.41 (1560)	10.47 (266)	19.68 (500)
18 (450)	3.50 (89)	22.75 (578)	30.70 (780)	--	--	--	71.06 (1805)	68.50 (1740)	10.47 (266)	19.68 (500)
20 (500)	4.50 (114)	25.00 (635)	35.03 (890)	--	--	--	78.74 (2000)	76.77 (1950)	10.47 (266)	19.68 (500)
24 (600)	4.50 (114)	29.50 (750)	41.33 (1050)	--	--	--	88.58 (2250)	88.58 (2250)	10.55 (268)	19.68 (500)

Dimensions are approximate and subject to change. Consult factory for certified drawings.

Weights

Size (in.)	2	3	4	6	8	10	12	14	16	18	20	24
Weight (lbs)*	42	57	73	119	176	271	366	419	542	904	1323	2105
Size (mm)	50	80	100	150	200	250	300	350	400	450	500	600
Weight (kgs)*	19	26	33	54	80	123	166	190	246	410	600	955

*Approximate weights shown with direct mounted handwheel, consult factory for additional configurations.

Direct Mounted Handwheel

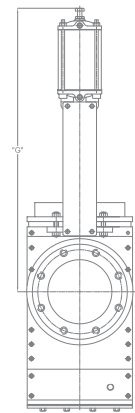
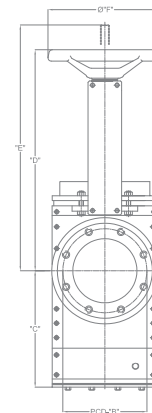

Pneumatic Actuator

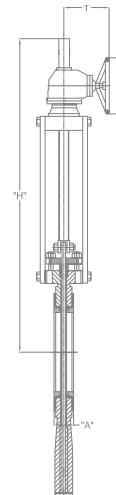

Bevel Gear

Consult factory for hydraulic and electric actuators dimensions.